



AVAILABLE FOR LEASE

PHOENIX PLAZA | 530 East North Bend Way, North Bend, WA 98045

SYD SEVERE
Office: 425.888.2993
Cell: 425.495.1353
Syd@mkps.net

TAYLOR LINDSEY
Office: 425.888.2993
Cell: 425.974.0010
Taylor@mkps.net



8124 FALLS AVE SE | SNOQUALMIE, WA 98065

425.888.2993 | WWW.MKPS.NET

PHOENIX PLAZA

ABOUT

PHOENIX PLAZA is a new construction multi-use building that is located in the highly sought after town of North Bend, WA. This project is scheduled to be completed by June of 2020 and is ready for your creative business/retail visions!

AVAILABLE	SQUARE FOOTAGE	RATE
Suite 100	approx. 200sf	\$650 per month/ Full Service
SUITES 101-102	1,928sf	\$25.00psf/Yr.; NNN

- **TI Allowance available for credit worthy Tenants.**
- Highly visible building located in the heart of Downtown North Bend on North Bend Way.
- Minutes from I-90 where 39,000 vehicles pass per day.
- Parking available in back of building.
- Picturesque location at the base of Mount Si.
- Strong area demographics and traffic counts.
- With 37 residential apartments on the upper 2 floors, you have a customer base right on site.
- Just minutes from over 200+ new construction homes that are currently under construction.



WEST ELEVATION

N.T.S.



EAST ELEVATION

N.T.S.

SYD SEVERE
Office: 425.888.2993
Cell: 425.495.1353
Syd@mkps.net

TAYLOR LINDSEY
Office: 425.888.2993
Cell: 425.974.0010
Taylor@mkps.net



8124 FALLS AVE SE | SNOQUALMIE, WA 98065

425.888.2993 | WWW.MKPS.NET

PHOENIX PLAZA

FLOOR PLAN

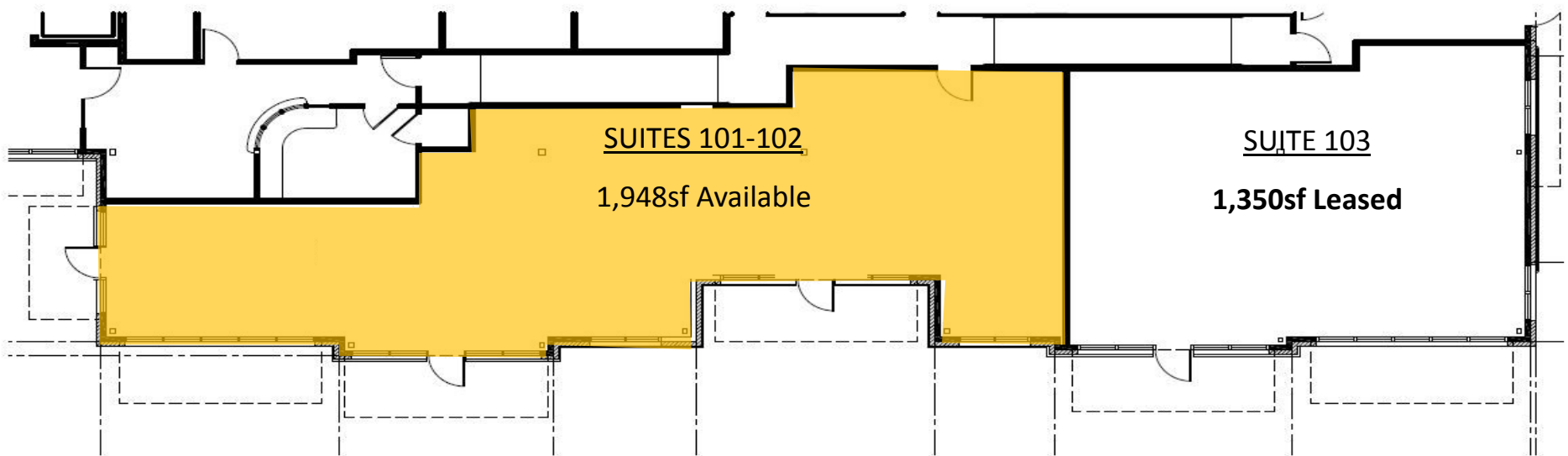

SYD SEVERE
Office: 425.888.2993
Cell: 425.495.1353
Syd@mkps.net

TAYLOR LINDSEY
Office: 425.888.2993
Cell: 425.974.0010
Taylor@mkps.net



8124 FALLS AVE SE | SNOQUALMIE, WA 98065

425.888.2993 | WWW.MKPS.NET

PHOENIX PLAZA

ABOUT NORTH BEND

Just 20 minutes east of Seattle, North Bend is thriving year round with tourism of all kind.

With a current population of 9,000 that is expected to double by year 2035 and just minutes from Snoqualmie Ridge, this is the ideal location for any retail or office user.

25,049
Total Population
<5 Miles

6,000
Daily Traffic
Count

\$140,922
Average Household
Income
<5 Miles

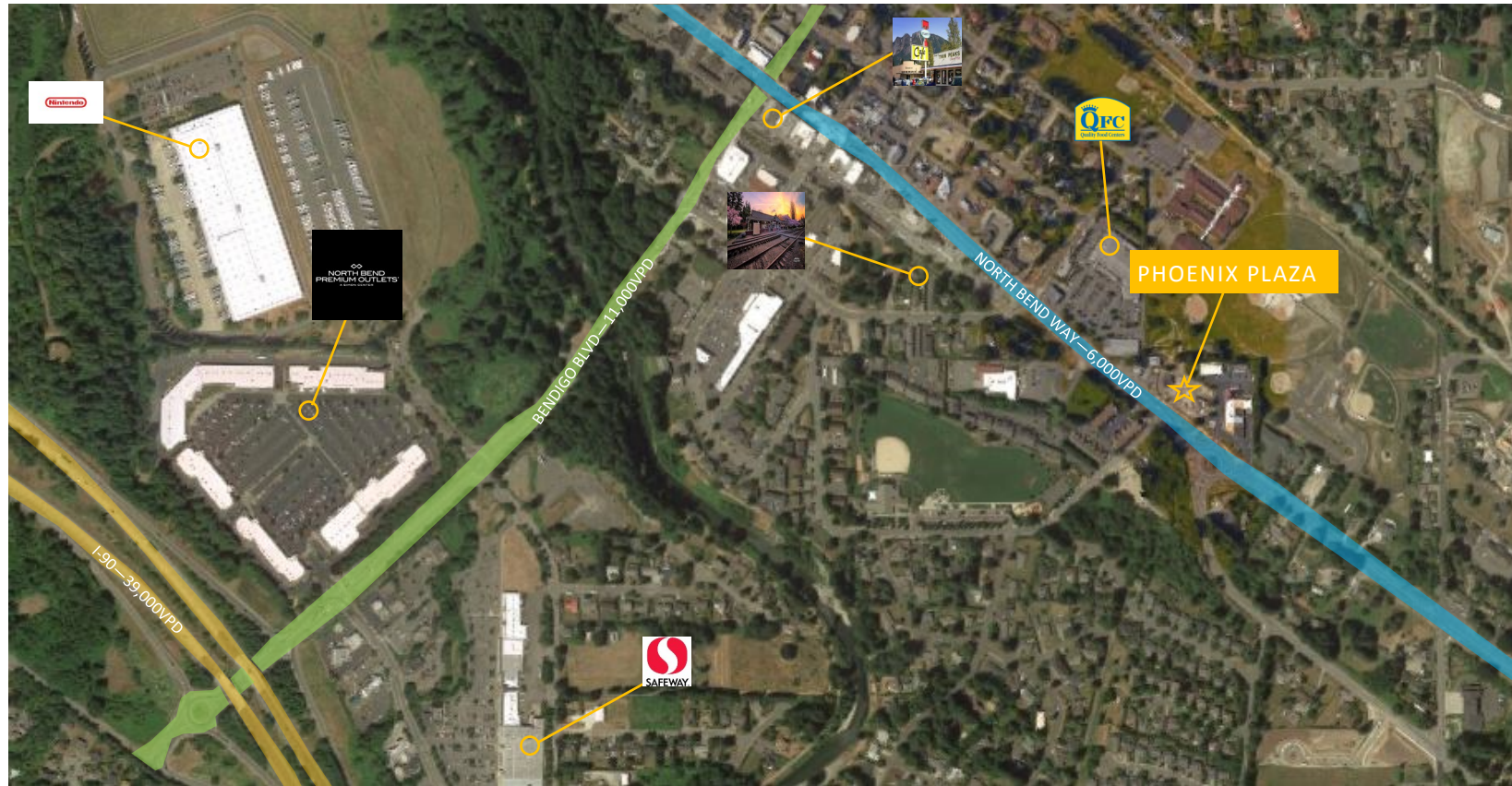

SYD SEVERE
Office: 425.888.2993
Cell: 425.495.1353
Syd@mkps.net

TAYLOR LINDSEY
Office: 425.888.2993
Cell: 425.974.0010
Taylor@mkps.net



8124 FALLS AVE SE | SNOQUALMIE, WA 98065

425.888.2993 | WWW.MKPS.NET

The information supplied herein is deemed reliable but without any representation, warranty or guarantee, expressed or implied, as to its accuracy. Prospective Buyer/Tenant should independently investigate all material matters. Consult your attorney, accountant or other professional advisor.